

*The Minnesota State High School League provides educational opportunities for students through interscholastic athletic and fine arts programs and provides leadership and support for member schools.*



Member of the National Federation of State High School Associations

## **IMPORTANT!**

### **RESPONSE DEADLINE: April 29, 2011**

ROUTE TO:   \_\_\_ Superintendent  
              \_\_\_ Principal  
              \_\_\_ Athletic Director  
              \_\_\_ Director Fine Arts

April 11, 2011

To:         Designated School Representative  
From:      Lisa Lissimore, Associate Director  
Re:         Hall of Fame Induction Ceremony

The date for the Minnesota State High School League Hall of Fame Induction Ceremony is fast approaching, and we hope that you will join us as we honor the 2011 Hall of Fame Inductees on Sunday, May 15, at the Edinburgh USA Golf & Event Center (8700 Edinbrook Crossing, Brooklyn Park, MN).

The Hall of Fame induction ceremony begins at 1:00 p.m. Individual tickets are **\$25**. Tables for 8 may be purchased for \$200. Checks may be made out to the **MINNESOTA STATE HIGH SCHOOL LEAGUE**. The tickets and tables will be awarded on a first come basis AND must be paid for in advance. SPACE IS LIMITED. To confirm your reservations please complete the enclosed form and return it on or before April 29, 2011.

We are looking forward to seeing you at the 2011 Annual Hall of Fame Induction Ceremony.

This year's inductees are:

<b>NOMINEE</b>	<b>CATEGORY</b>	<b>SCHOOL OR RESIDENCE</b>
Geri Dirth	Coach	Apple Valley
Don Fosburgh	Fine Arts Director/Adjudicator	St. Peter
Nancy Grimes	Fine Arts Director	Apple Valley
Zigurd "Ziggy" Kauls	Coach	Mounds View
Mike Kingery	Athlete	Atwater
James Kovalski	Athletic Official	Waconia
Norman Kragseth	Athlete	Duluth Central
Milan Mader	Coach	Lakeville North
Robert Nangle	Athletic Director	Pipestone
Tom Saterdalen	Coach	Bloomington Jefferson
William "Chuck" Scanlon	Coach	Apple Valley
Dean Verdoes	Athletic Director/Coach	Henry Sibley
Eugene "Lefty" Wright	Athletic Official/Coach	St. Louis Park



# 2011 HALL of FAME INDUCTION CEREMONY

Sunday, May 15, 2011

Please reserve \_\_\_\_\_ place(s) in my name at \$25 per person

Please reserve \_\_\_\_\_ table(s) for 8 at \$200 per table

Enclosed is my check for \$\_\_\_\_\_ payable to:

**MINNESOTA STATE HIGH SCHOOL LEAGUE**  
**Payment must accompany reservation request.**  
**No phone orders will be accepted.**

\* Name \_\_\_\_\_

Home Address \_\_\_\_\_

\_\_\_\_\_

Phone (\_\_\_\_\_) \_\_\_\_\_

*\* All tickets for this order will be reserved under the name above.*

Seating is reserved and tickets may be picked up on Sunday, May 15 at the Hall of Fame registration table located outside the ballroom.

**Return this form on or before April 29, 2011 to:**

Hall of Fame Banquet  
MSHSL  
2100 Freeway Blvd.  
Brooklyn Center, MN 55430-1735

# Directions to Edinburgh USA Golf & Event Center

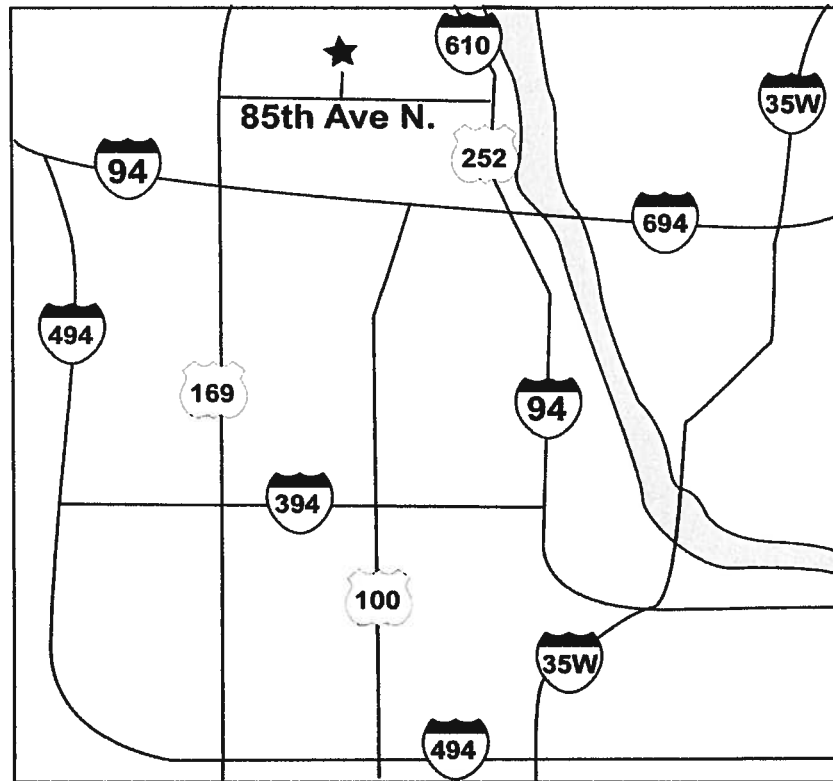

## **DIRECTIONS FROM THE:**

**North** - Hwy 10 - to Hwy 610 South - to Hwy 252 South - to 85th Avenue North - Go West (right) on 85th for 1.25 miles - to Edinbrook Crossing - make a Right Turn

**South** - 35W North - to 94 West - to Hwy 252 North - to 85th Avenue North - Go West (left) on 85th for 1.25 miles - to Edinbrook Crossing - make a Right Turn

**West** - Hwy 169 North - to 85th Avenue North - Go East (right) on 85th for 4 miles - to Edinbrook Crossing, make a Left Turn

**East** - Hwy 694 West - to 252 North - to 85th Avenue North - Go West (left) on 85th for 1.25 miles - to Edinbrook Crossing - make a Right Turn